

# ***ORANGE BLOSSOM EXPRESS***

***Lake County 2<sup>nd</sup> Annual Green Symposium***

**JULY 2010**



Orange  
Blossom  
EXPRESS

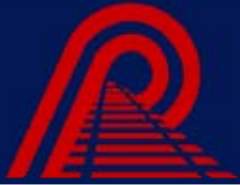

# *Apopka Station*



**New Streamlined DMU**  
**Self-Propelled Commuter Rail Vehicle**  
**Meets the FRA's part 238 Safety Specifications**



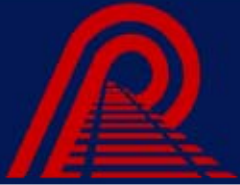

# Tavares Station

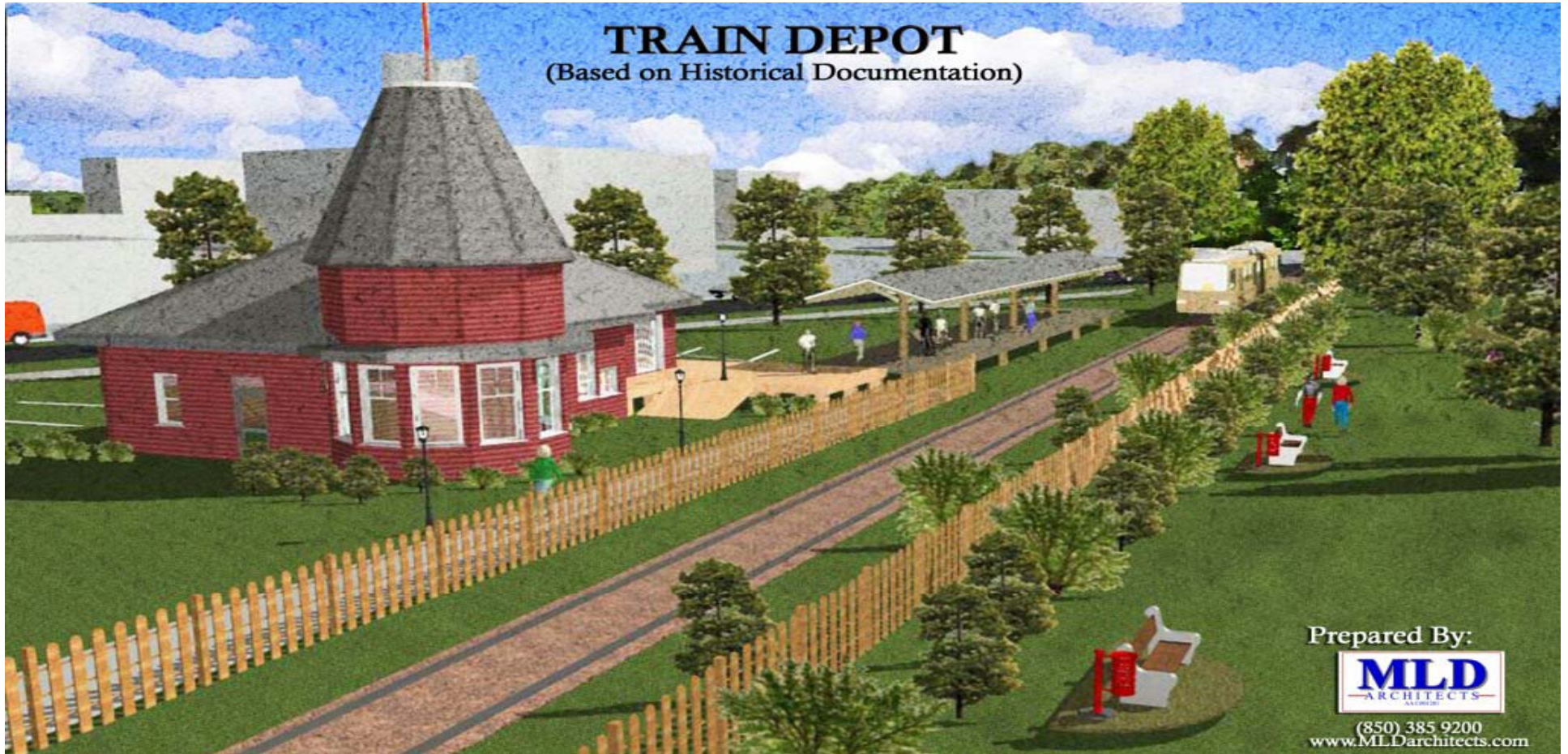

# LYNX Interface



# Completed System – 35.5 Miles

## Potential Station Locations

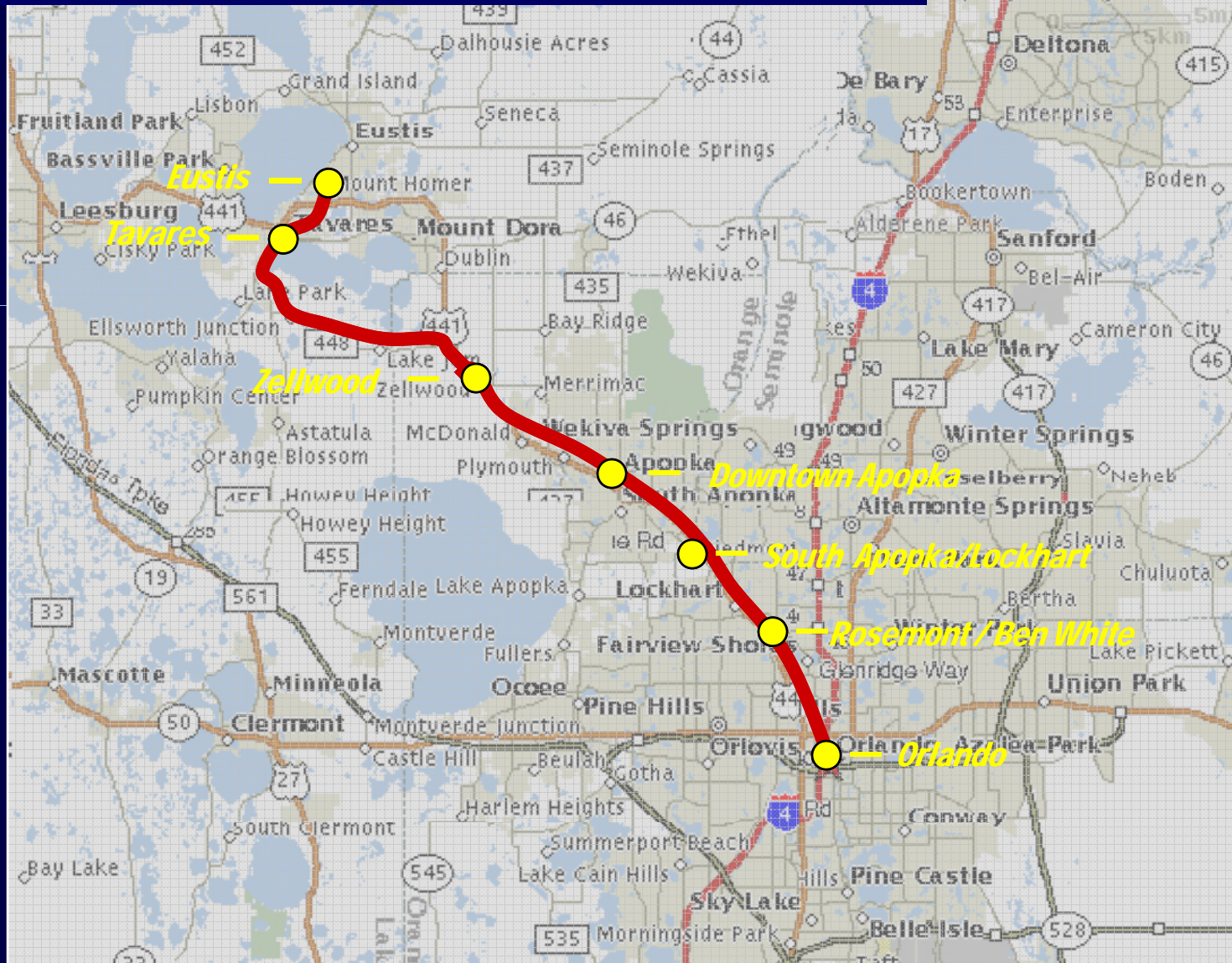

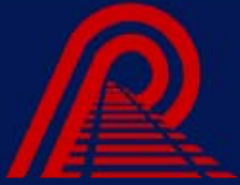

# Evaluation of Alternatives

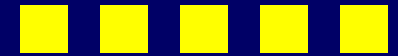

## Transit Travel Time Comparisons

<u>From</u>	<u>TO</u>	<u>Bus Time</u>	<u>Rail</u>	<u>Difference</u>
Zellwood	Apopka	0:28	0:12	0:16
	Rosemont	1:12	0:25	0:47
	Orlando CBD	1:35	0:36	0:59
Apopka	Rosemont	0:17	0:13	0:04
	Orlando CBD	0:40	0:24	0:16
Rosemont	Orlando CBD	0:23	0:11	0:12



# ***ORANGE BLOSSOM EXPRESS***

***FLORIDA CENTRAL RAILROAD***

**The Next Piece of the Central Florida Commuter Rail System**

